

KEY

⌘ double 13A switched socket outlet

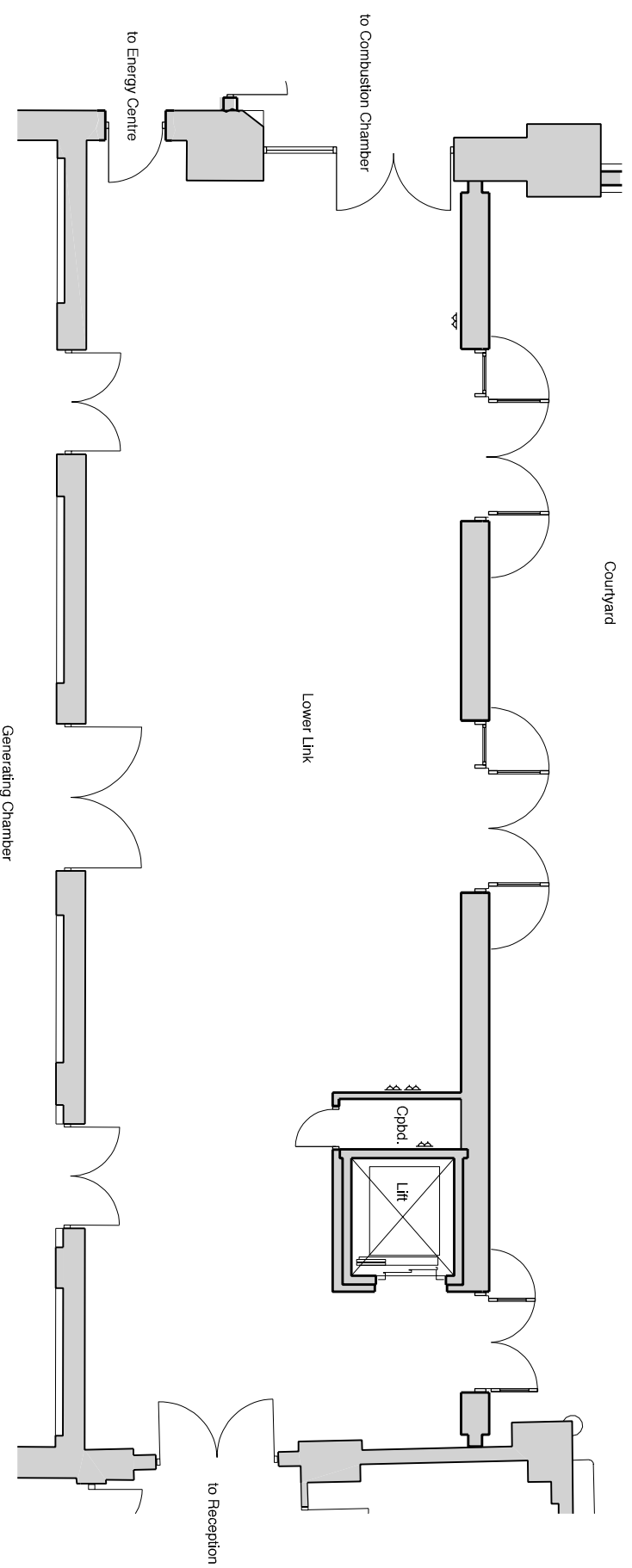

## THE CIRCUS SPACE

### LINK GROUND FLOOR PLAN

SCALE 1:50 at A1 sheet size  
1:100 (approx.) at A3 sheet size



Drawing Ref. No. TCS 1093 B

ACCURACY:  
Please note that this drawing is based on the following information:  
PCA survey drawings (1989, digitised Nov. 2004), Philip Lanchester Phase 2 Plans (1995),  
TheatreTech proposals (2004), TRA site observation (2005), Phase 3 construction  
drawings (2006) and site measurement by The Circus Space January 2008.  
Typical accuracy: +/- 50mm. (Accuracy of +/- 50mm is not asserted for every instance.)