

DO NOT SCALE

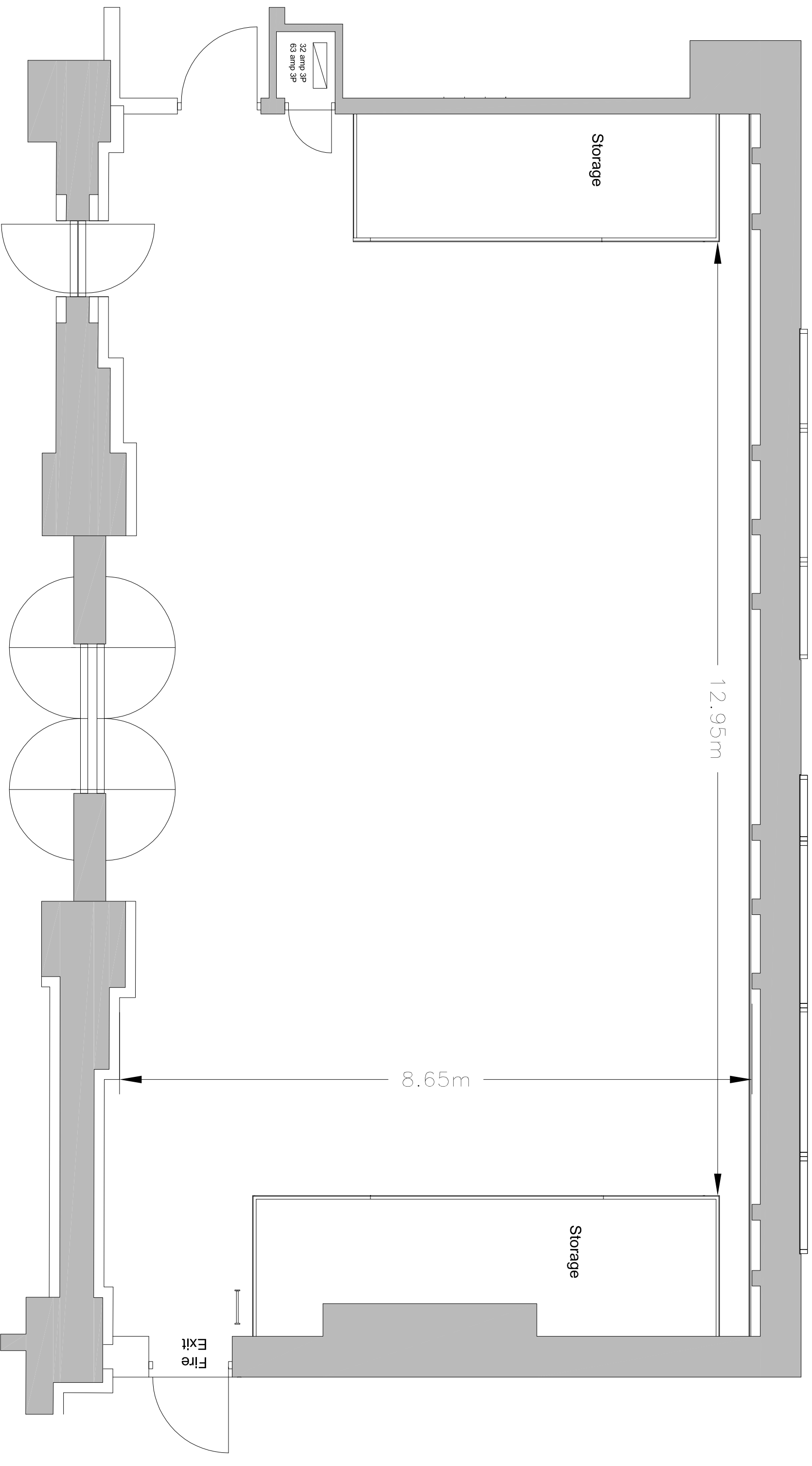

**Creation Studio**

- 12.9m x 8.3m clear floor space. Height to ceiling 6.1m.
  - Permanently rigged truss at 5.7m with three multiple purchase lifting systems. Other rigging options available.
  - 10 x 500kg SWL Floor points spread down either side of the room.
  - Additional 500kg ceiling and wall rigging points available on request.
  - Wall points are approx 3100mm above floor
  - The allowable loads are maximum static equivalent loads which can be safely applied to the truss and/or points.
- No allowance has been made for dynamic loads.**

<b>national centre for circus arts</b>	
Coronet Street, London, N1 6HD Tel: 020 7615 4141 www.nationalcircus.org.uk	
project	date
client	JUNE 2016
venue	CREATION STUDIO
drawing title	scale 1:50 on A3
Plan	
drawn by	drawing no.